

# PARKLANE 185

We include what many others call extras!

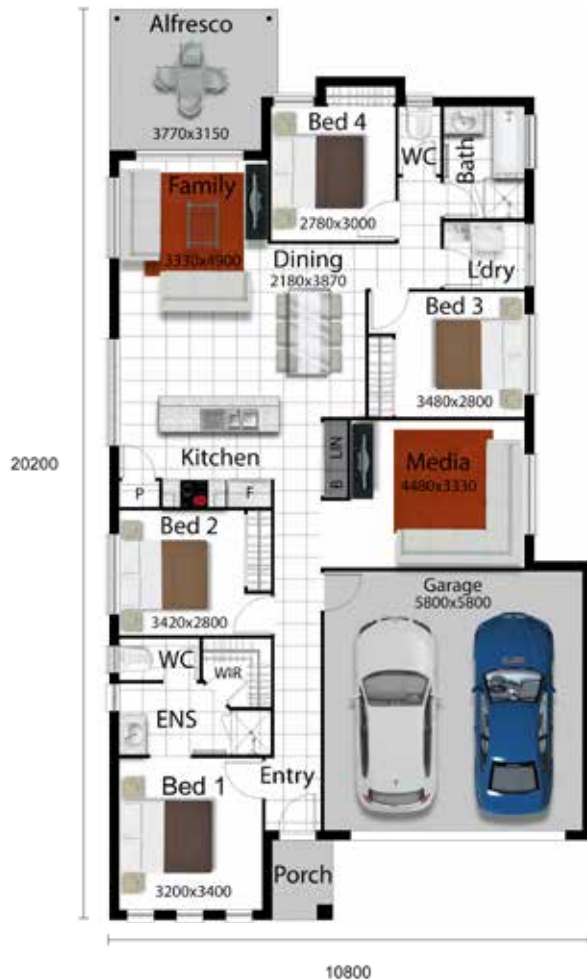

Lot 1116 Crabapple Crt

Riverparks Estate

Land Size: 400m<sup>2</sup>

HOUSE & LAND PRICE:

**\$371,300**

Living	132.9m <sup>2</sup>
Car Accom	38.41m <sup>2</sup>
Alfresco	12.43m <sup>2</sup>
Porch	2.42m <sup>2</sup>
<b>Total Area</b>	<b>183.95m<sup>2</sup></b>

PACKAGE INCLUDES:



- 25 Year Structural Guarantee\*
- Smart Stone Kitchen bench
- 7.1Kw Split System Air Conditioning to Living/ Meals Area
- 2.5Kw Split System Air conditioning to Bed 1
- Quality European Appliances
- 6 Star Energy Rating
- Flyscreens Screens to openable windows
- Barrier screens to Sliding Doors
- Quality Carpets & Tiles
- Colourbond Roof

Kathy Kleidon  
0417 769 118



**Fresh Homes**

BUILT NEW JUST FOR YOU



Head Office: 4067 Pacific Highway Loganholme : 3806 0603 | freshhomes.com.au

Plans and images are for illustration only. Floor plan and elevation as shown in this brochure are artists impressions only and do not form any part of the contract to build. Standard plans and specifications take precedence over any design, elevation or brochure. These designs are exclusively the property of Fresh Homes and as such are copyright. QBCC No 1088603. Prices may change without notice. \*Applies to building structure only